

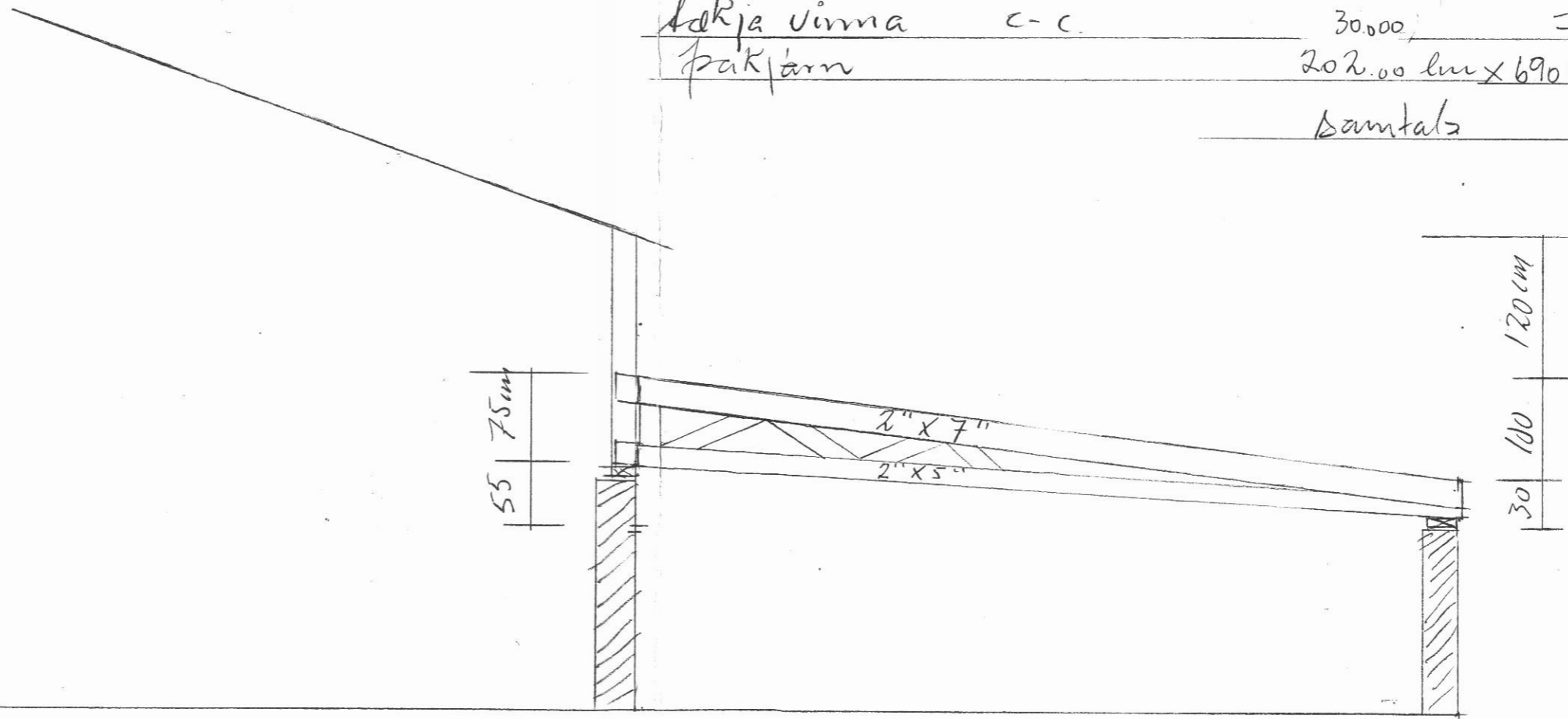

Spennur 2" x 7"	= 29 st 7.15 á l = 207.35 m x 254 =	52.666
- " - 2" x 5"	= 29 - 7.15 - = 207.35 - x 181 =	37.530
i krafta 2" x 5"	= 87.00 m x 181 =	15.747
i föstikk 2" x 4"	20.00 - x 135 =	2.700
langbönd 1" x 6"	300.00 m x 102 =	30.600
BMF festingar	58 st x 130 =	7.540
Samur c-c	(15.000)	15.000
Virna 140 linnar	1350 pr linn	189.000
lokja virna c-c	30.000	= 30.000
Þakjárn	202.00 linn x 690 =	139.104
Samtals		519.887



Skafur mynd af físi 1:50

Blífar mynd af traukhúsi

af Hofjörðkoti Svafataradal

24/ápríl '90 Kinnar Þósson