

SNID - C 1:20

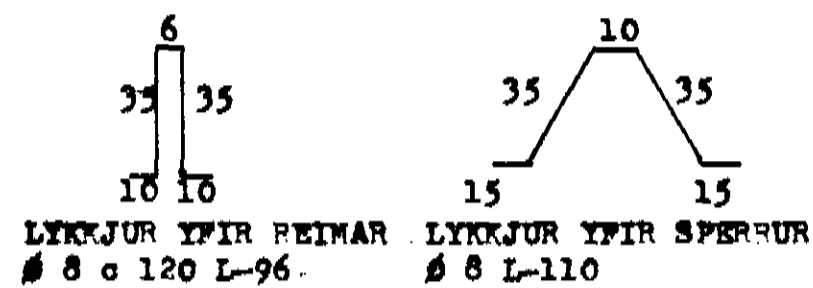

ANEGGLI 2 STR. 1"x 6" L-60 CM  
3/4 NAGLAR

LEFTUN Á ÞAKI  
1 1/2" PLASTIRUR  
BIL SANKI - RYGGINGARÞAND.

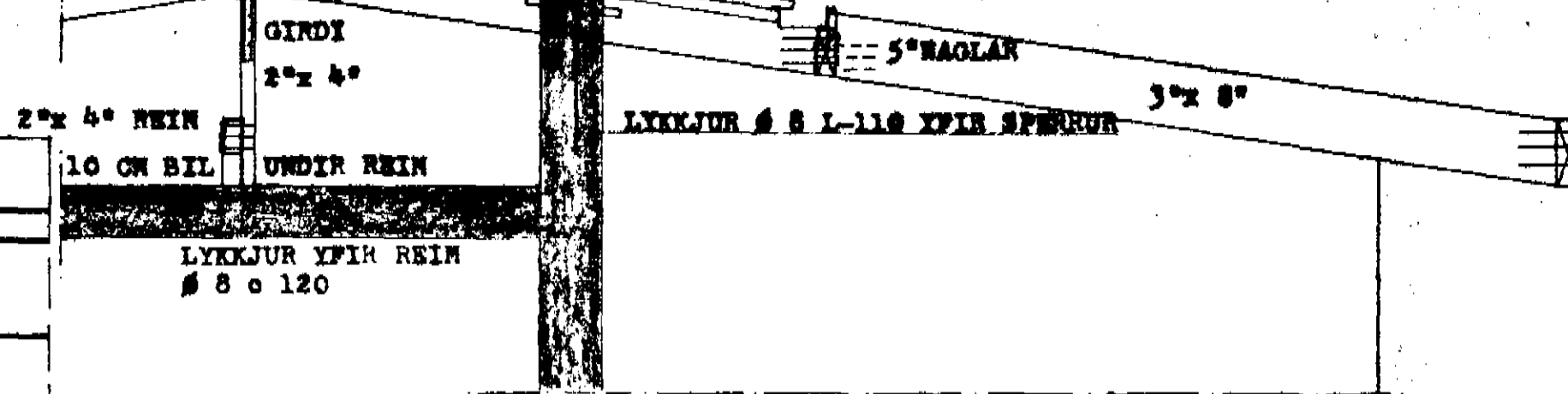

SNID - A 1:20

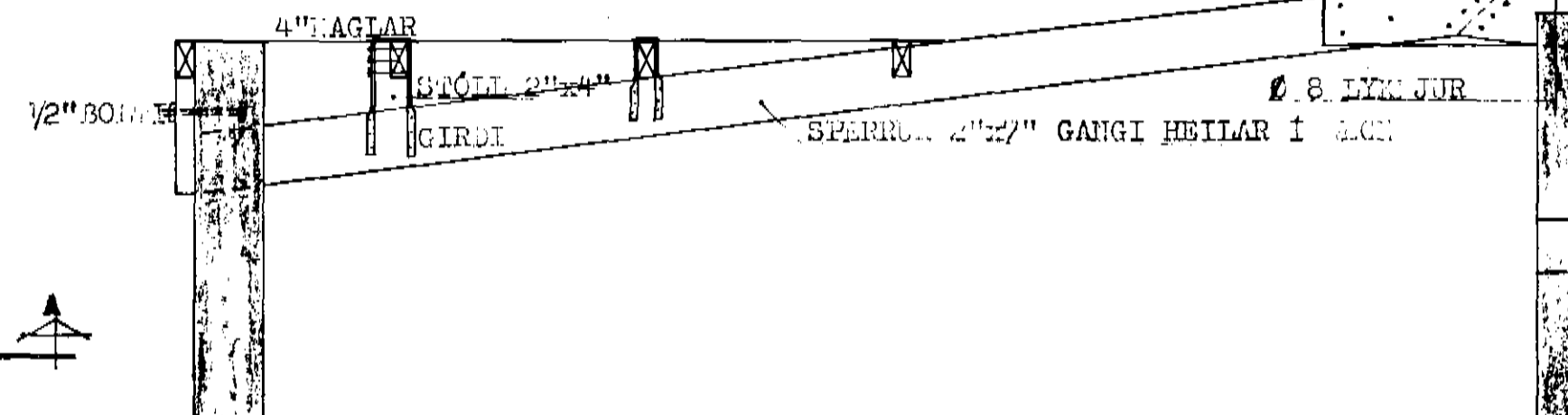
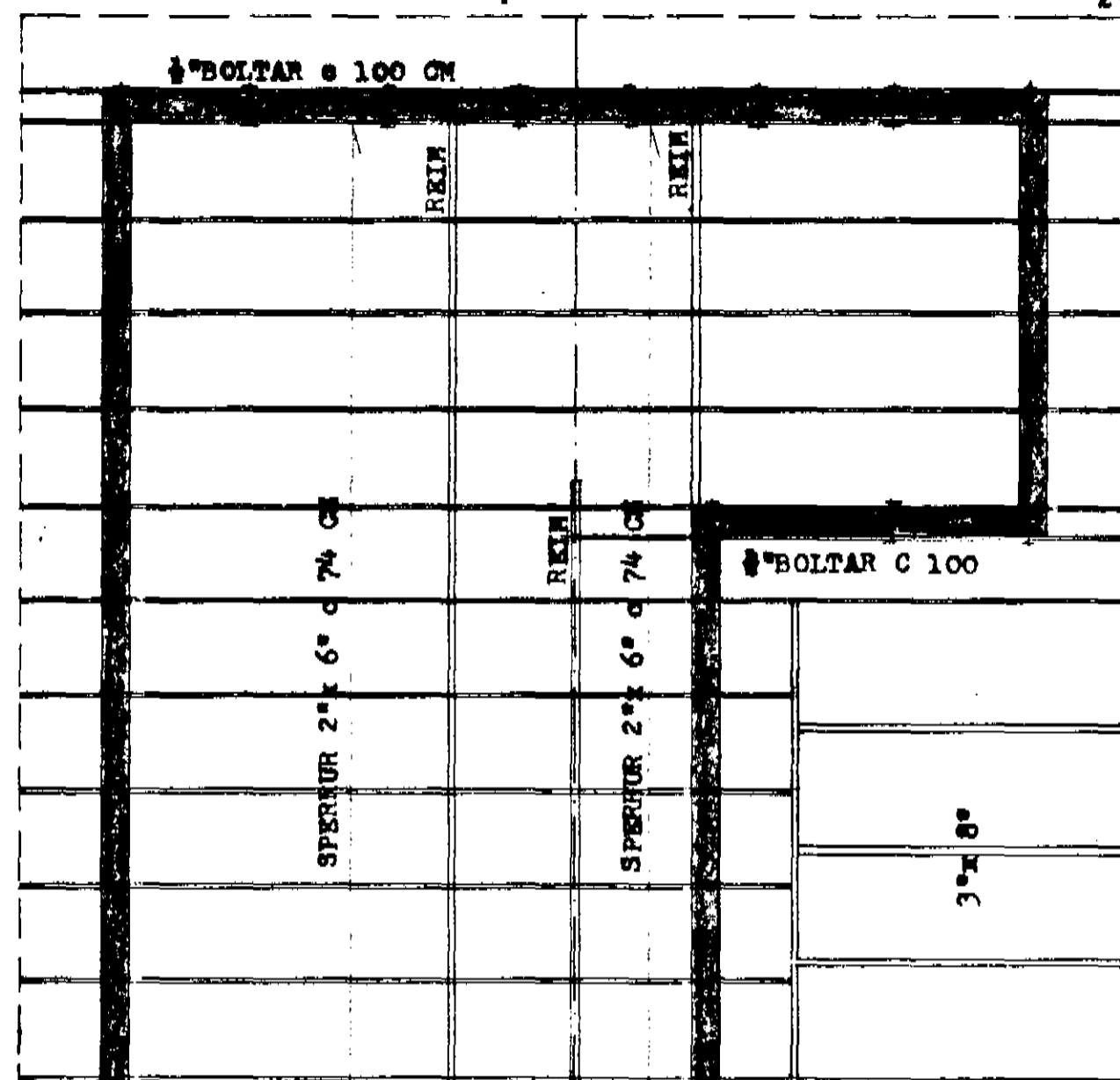

SNID - B 1:20

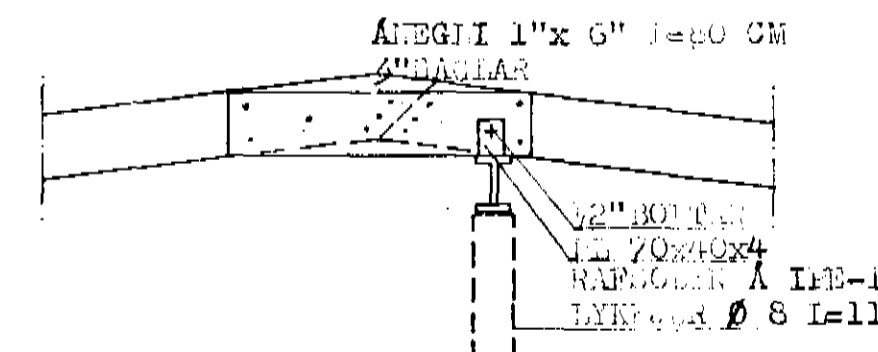
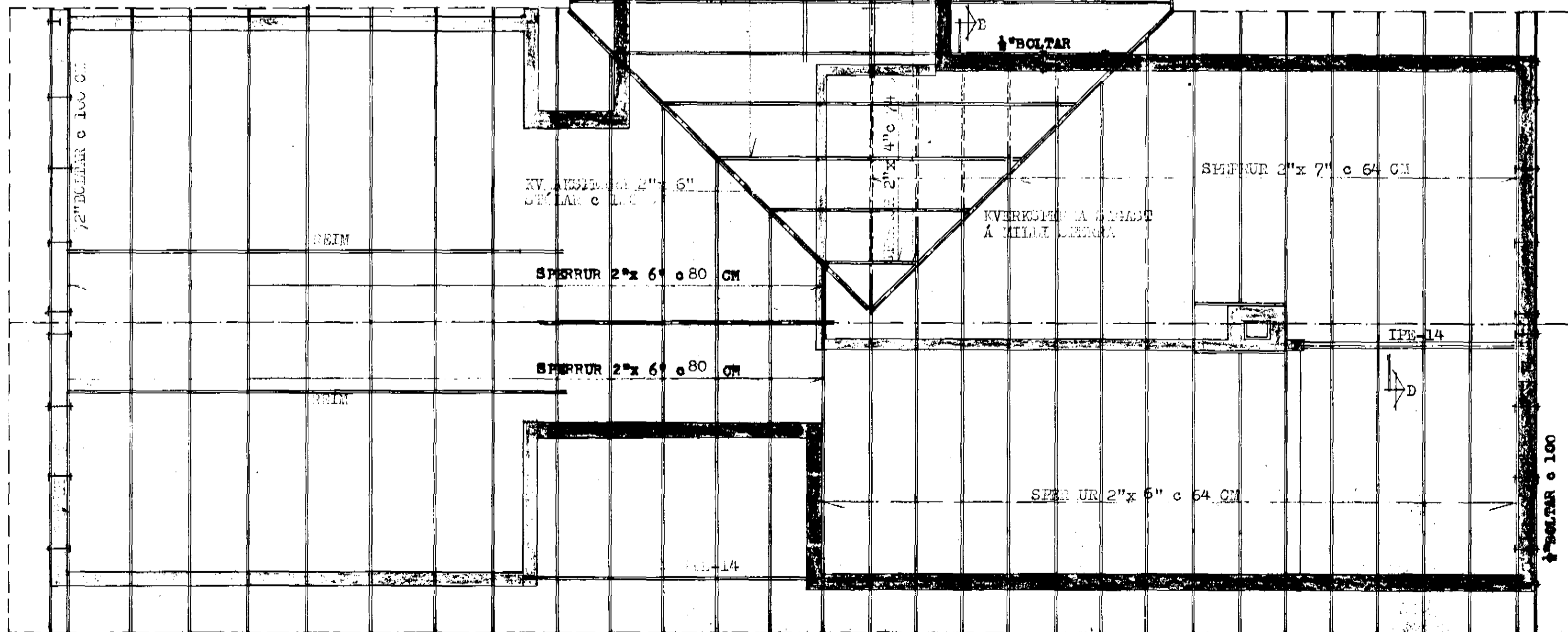

SNID - D 1:20

**SKÝRINGAR:**

SPERRUR OG STÓLAR SEM LIGGJA Í EDA AD STEYFU SKAL ÞÓVERJA MED TD. C-TOX. ALLUR ÞAKSAUMUR OG BOLTAR SKAL VERA GALVANISERUÐ. STÁLÞEIT OG FESTINGAR SKAL RYGGINGARÞAND. MÖLJA OG MÁLA MED RYÐVA RANA.MATNINGU.

**DALDR. 7.**

STEINORÍMUR TR. ÞORLEIFSSON MFI

ÞRUBRAUÐ 11, DALVIK

MÁL	1:20 1:50	SÁKRYTAN
DAÐS.	JAN. 1976	GRUNNYND OG SNID
BLAD	8	

ÞJÁ SNID - D